

MONSOON

Universal Single Pumps

MONSOON Universal Single pumps can be used in pairs to boost hot and cold water supplies in vented systems independently, or as a single pump to boost a water supply as required.

MONSOON Universal pumps are fully automatic, do not require a gravity flow of water to start and are suitable for both positive and negative head applications.



Features

- 5 year warranty
- 2.0 – 4.5 bar options
- Suitable for positive or negative head applications
- Premium quality brass pump supplied with anti-vibration hoses
- Very quiet operation
- WRAS approved product / Kiwa KUKreg4
- Continuously rated
- Anti-vibration feet
- EPDM/PTFE/Al. Oxide seal
- Pre-wired with 1.5 metre power cable
- UK: Supplied with 22mm push-fit x 310mm anti-vibration flexible hoses with integral isolating valves
- ROI: Supplied with 21mm push-fit x 305mm anti-vibration flexible hoses with integral isolating valves
- Export: Supplied with G 3/4F x 318mm anti-vibration flexible hoses

Application

- Boosting hot and cold water supplies to taps, showers, a complete bathroom or the whole house in low pressure open-vented / gravity systems
- Suitable for use where there is less than 1 litre/min flow from the outlet(s) to be boosted

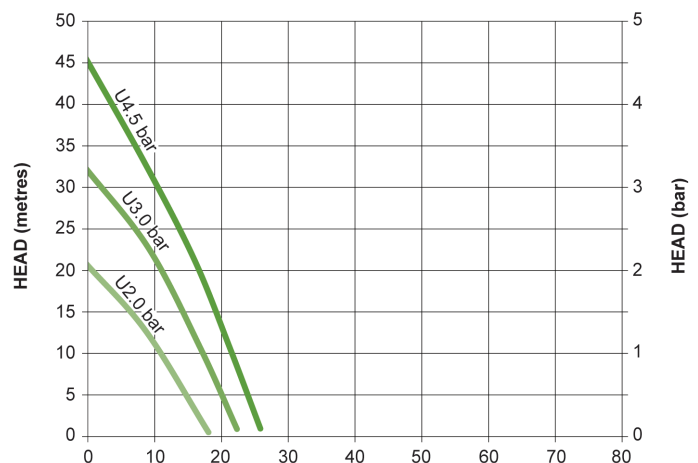

		U2.0 bar Single 46498	U3.0 bar Single 46413	U4.5 bar Single 46414
GENERAL	Warranty	5 years (subject to conditions)		
	Approval certification	WRAS Approved Product Kiwa UK (KUKreg4)		
	Conformity certification	UKCA CE		
FEATURES	Pump type / pump control	Peripheral / pressure & flow switch		
	Anti-vibration feet	✓	✓	✓
	Inlet strainer(s)	✓	✓	✓
	Flexible hoses	2	2	2
	Run on Timer	3 sec	3 sec	3 sec
	Dry run protection	✓	✓	✓
	Typical noise	42 dB(A)	48 dB(A)	55 dB(A)
	PERFORMANCE	Maximum head – closed valve	2.0 bar	3.2 bar
Performance @ 9 l/min		1.2 bar	2.5 bar	3.5 bar
Performance @ 18 l/min		-	0.9 bar	1.7 bar
Maximum flow		18 l/min	22 l/min	26 l/min
Maximum static inlet pressure		8 metres	12 metres	
Maximum static outlet pressure		8 metres	12 metres	
Maximum working pressure*		600 kPa (6 bar)		
Maximum ambient air temperature		40 °C		
Min / Max water temperature**		Min 4 °C / Max 65 °C		
Flow switch sensitivity		0.6 l/min (approx)		
Pressure vessel air pre-charge		0.9 bar (13 psi)	1.3 bar (18.5 psi)	
CONSTRUCTION		Enclosure protection	IPX4	
	Pump Body / impeller	Brass		
	Mechanical seal	EPDM / PTFE / Al. Oxide		
CONNECTIONS	Pump connections	G ¾ M		
ANTI-VIBRATION HOSES	Connections (UK model)	G ¾ F x 22 mm push-fit x 310 mm long ± 5mm, isolating valves on all hoses		
	Connections (ROI model)	G ¾ F x 21 mm push-fit x 305mm long ± 5mm, isolating valves on all hoses		
	Connections (Export model)	G ¾ F x G ¾ F x 318 mm long ± 5mm		
MOTOR	Type	Induction (auto-reset thermal trip)		
	Duty rating	Continuous (S1) @ 9 l/min and above		
ELECTRICAL	Power supply (Vac/Ph/Hz)	230 V a.c. / 1 / 50 Hz		
	Current – full load	1.1 Amps	1.7 Amps	2.5 Amps
	Power consumption – P1	250 Watts	390 Watts	555 Watts
	Fuse rating	5 Amps		
	Power cable length	1.5 metres		
DIMENSIONS	Length	200 mm		
	Width	162 mm		
	Height – excluding hoses	243 mm		
	Weight – including fittings	6.6 Kg		7.3 Kg

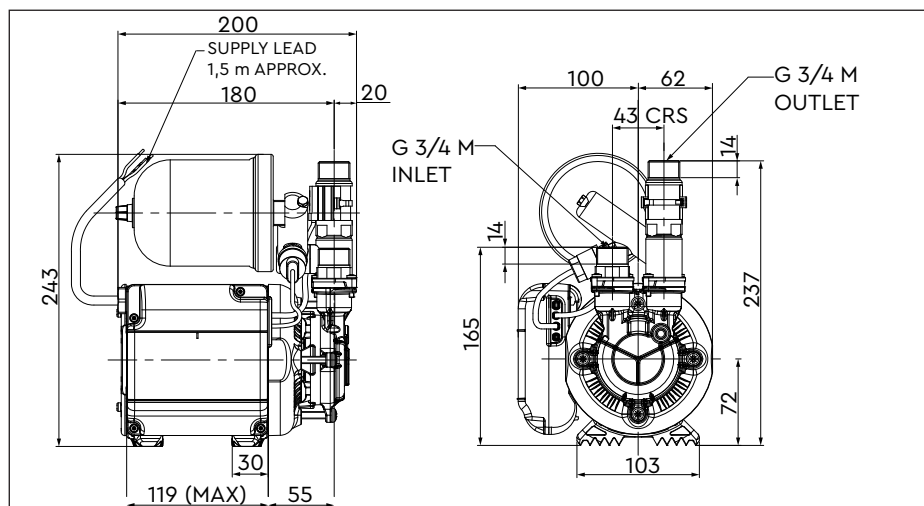

* The maximum pressure that can be applied to the pump under any installation conditions.

** A stored water temperature of 60 °C is considered sufficient to meet all normal requirements and will minimise deposition of scale in hard water areas.

Stuart Turner Limited reserves the right to amend specifications without notice.